

# FRONT BUMPER COMPONENTS

760VD-01

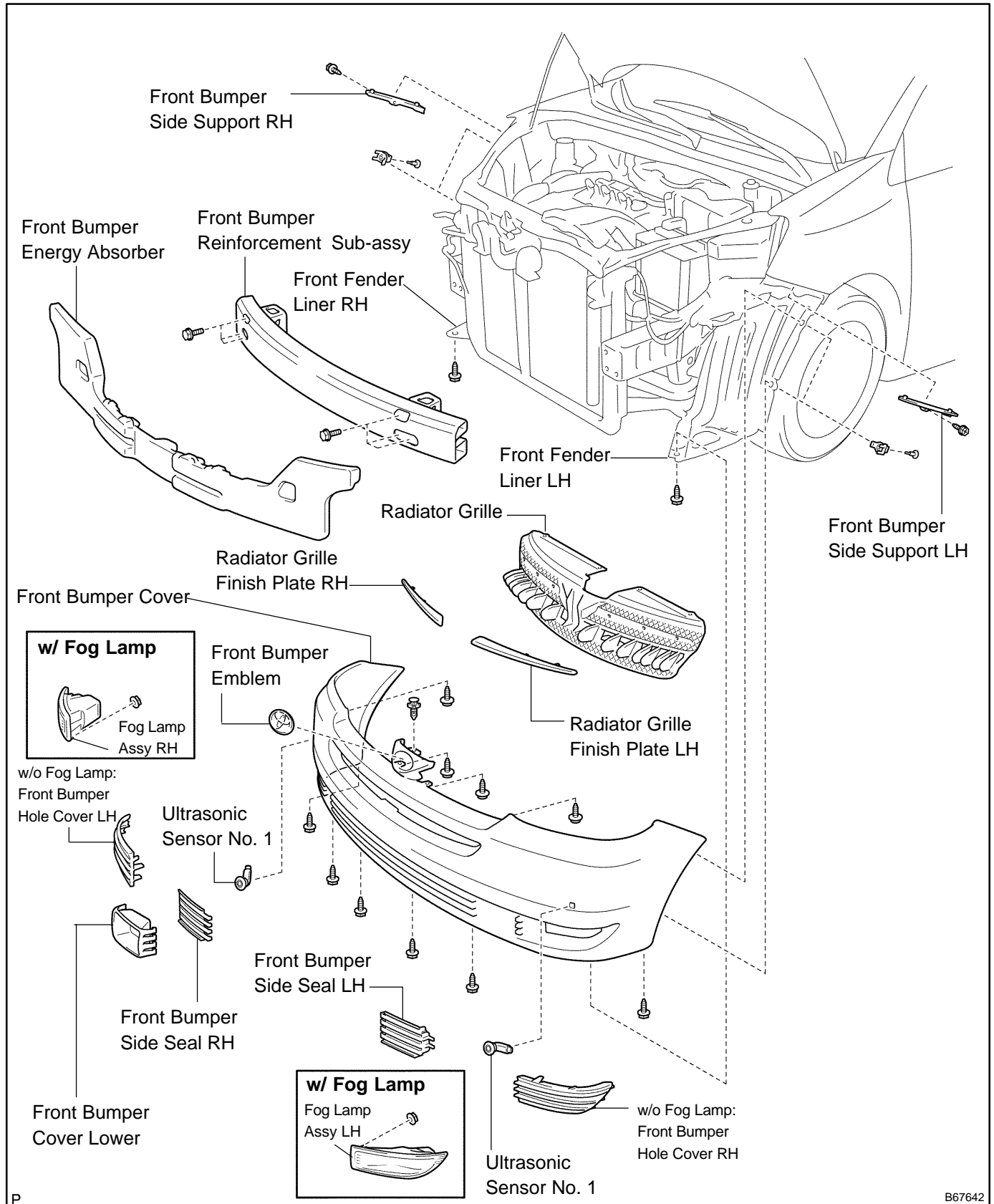

## REPLACEMENT

### HINT:

The installation is in the reverse order of the removal. However, when there is a special point concerning the installation, it is indicated.

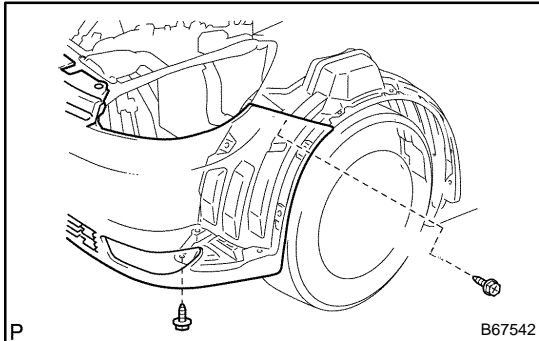

### 1. REMOVE FRONT FENDER LINER LH

- (a) Remove the 2 screws.
- (b) Partially the fender liner.

### HINT:

Do not remove the fender liner completely but partially so that the bumper cover can be removed.

### 2. REMOVE FRONT FENDER LINER RH

### HINT:

Use the same procedures above for the LH side.

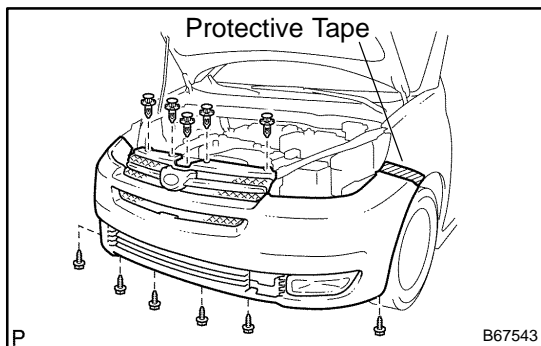

### 3. REMOVE FRONT BUMPER COVER

- (a) Put protective tape under the front fender.
- (b) w/ Fog lamp:  
Disconnect the fog lamp connectors.
- (c) Remove the 6 screws, 4 clips and the bumper cover.

### 4. REMOVE ULTRASONIC SENSOR NO.1 (LH)

- (a) Remove the bolt and sensor.

### 5. REMOVE ULTRASONIC SENSOR NO.1 (RH)

- (a) Remove the bolt and sensor.

### 6. REMOVE FRONT BUMPER ENERGY ABSORBER

### 7. REMOVE FRONT BUMPER REINFORCEMENT SUB-ASSY

- (a) Remove the 6 bolts and reinforcement.

### 8. REMOVE FRONT BUMPER SIDE SUPPORT LH

- (a) Remove the bolt.
- (b) Using a screwdriver, remove the side support.

### HINT:

Tape the screwdriver tip before use.

### 9. REMOVE FRONT BUMPER SIDE SUPPORT RH

### HINT:

Use the same procedures above for the LH side.

### 10. REMOVE RADIATOR GRILLE FINISH PLATE LH

- (a) Using a screwdriver, disengage the 3 claws and remove the finish plate.

### HINT:

Tape the screwdriver tip before use.

**11. REMOVE RADIATOR GRILLE FINISH PLATE RH**

HINT:

Use the same procedures above for the LH side.

**12. REMOVE RADIATOR GRILLE****13. REMOVE FRONT BUMPER EMBLEM****14. REMOVE FRONT BUMPER HOLE COVER LH (W/O FOG LAMP)****15. REMOVE FRONT BUMPER HOLE COVER RH (W/O FOG LAMP)****16. REMOVE FOG LAMP ASSY LH (W/ FOG LAMP)**

(a) Remove the nut and fog lamp.

**17. REMOVE FOG LAMP ASSY RH (W/ FOG LAMP)**

(a) Remove the nut and fog lamp.

**18. REMOVE FRONT BUMPER COVER LOWER**

(a) Disengage the 7 claws and remove the cover.

**19. REMOVE FRONT BUMPER SIDE SEAL LH**

(a) Disengage the 6 claws and remove the side seal.

**20. REMOVE FRONT BUMPER SIDE SEAL RH**

(a) Disengage the 6 claws and remove the side seal.

**21. INSTALL FRONT BUMPER REINFORCEMENT SUB-ASSY**

(a) Install the reinforcement with the 6 bolts.

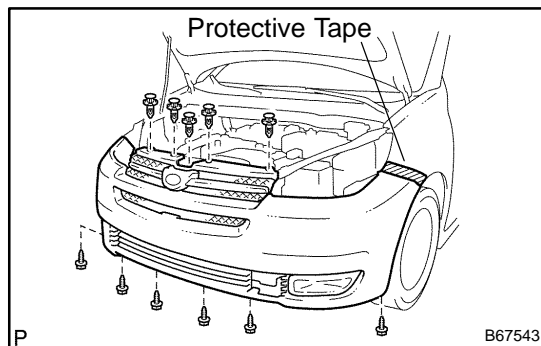
**Torque: 50 N·m (510 kgf·cm, 37 ft·lbf)****22. INSTALL FRONT BUMPER COVER**

(a) w/ Fog lamp:

Connect the fog lamp connectors.

(b) Install the cover with the 6 screws and 4 clips.

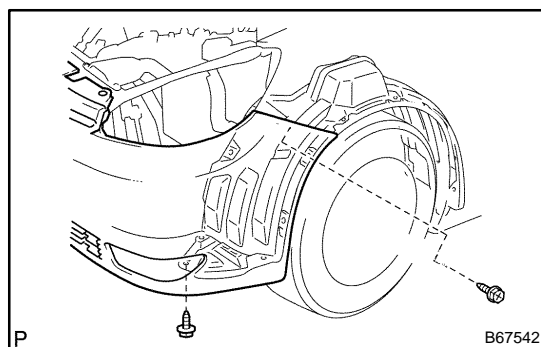
**23. INSTALL FRONT FENDER LINER LH**

(a) Install the fender liner with the 2 screws.

**24. INSTALL FRONT FENDER LINER RH**

HINT:

Use the same procedures above for the LH side.

# REAR BUMPER COMPONENTS

760VF-01

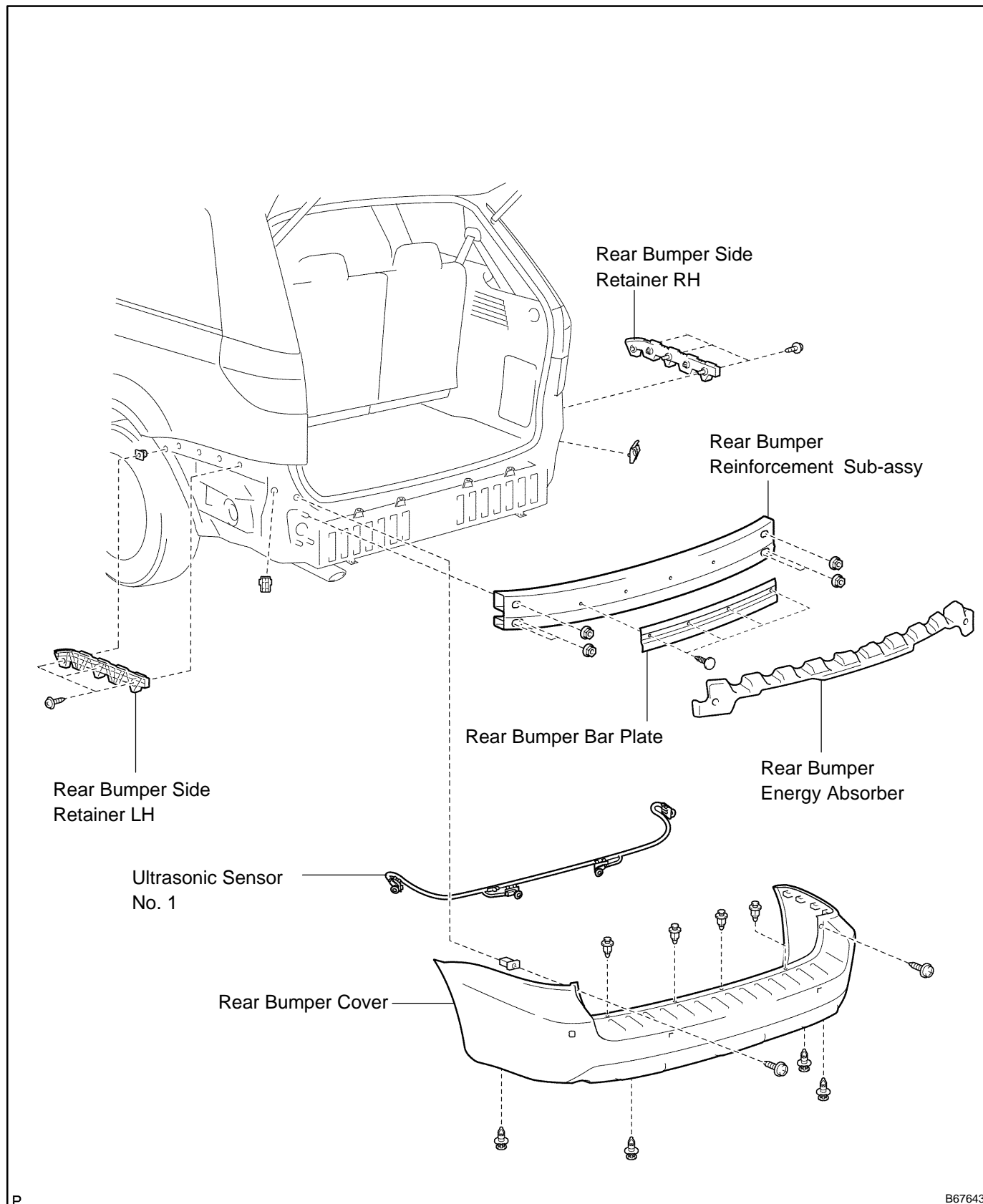

## REPLACEMENT

### HINT:

The installation is in the reverse order of the removal. However, when there is a special point concerning the installation, it is indicated.

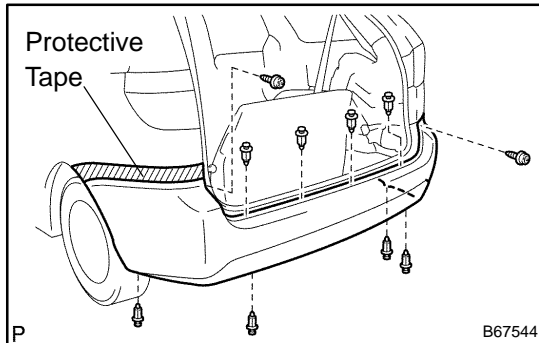

### 1. REMOVE REAR BUMPER COVER

- (a) Put protective tape under the quarter panel.
- (b) Partially the fender liner.

### HINT:

Do not remove the fender liner completely but partially so that the bumper cover can be removed.

- (c) Remove the 2 screws and 8 clips.
- (d) Using a screwdriver, disengage the claws and remove the cover.

### HINT:

Tape the screwdriver tip before use.

### 2. REMOVE ULTRASONIC SENSOR NO.1

### 3. REMOVE REAR BUMPER ENERGY ABSORBER

### 4. REMOVE REAR BUMPER BAR PLATE

- (a) Remove the 4 clips and bar plate.

### 5. REMOVE REAR BUMPER REINFORCEMENT SUB-ASSY

- (a) Remove the 6 nuts and reinforcement.

### 6. REMOVE REAR BUMPER SIDE RETAINER LH

- (a) Remove the 3 screws and side retainer.

### 7. REMOVE REAR BUMPER SIDE RETAINER RH

- (a) Remove the 3 screws and side retainer.

### 8. INSTALL REAR BUMPER REINFORCEMENT SUB-ASSY

- (a) Install the reinforcement with the 6 nuts.

**Torque: 50 N·m (510 kgf·cm, 37 ft·lbf)**

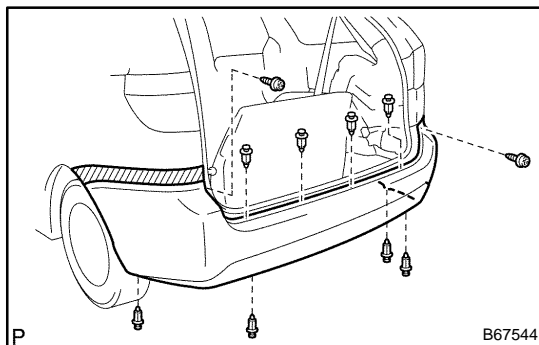

### 9. INSTALL REAR BUMPER COVER

- (a) Install the cover with the 2 screws and 8 clips.

# NAME PLATE REPLACEMENT

760VH-01

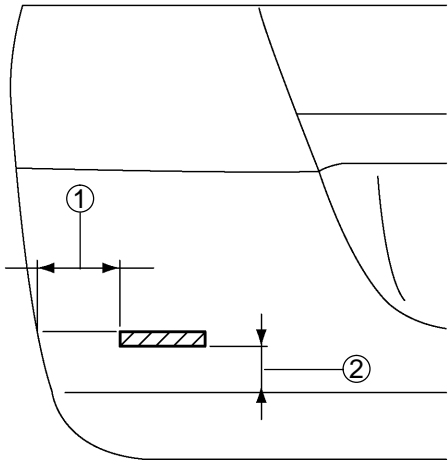
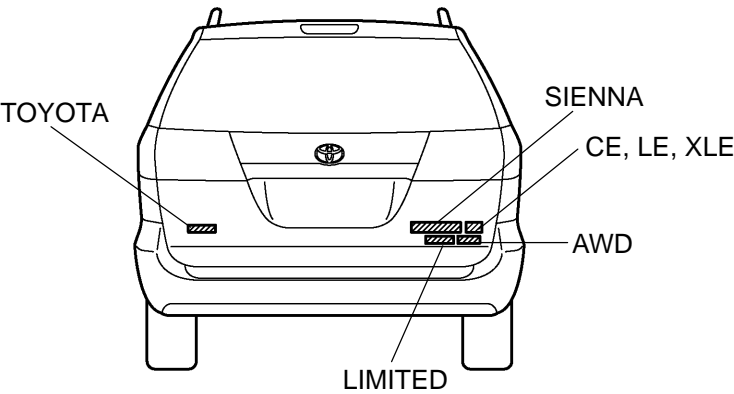

TOYOTA

Dimension

①	61.8 (2.433)	②	38.2 (1.504)
---	--------------	---	--------------

mm (in.)

SIENNA CE

Dimension

①	38.8 (1.528)	②	25.4 (1.000)
③	57.8 (2.276)	④	38.8 (1.528)

mm (in.)

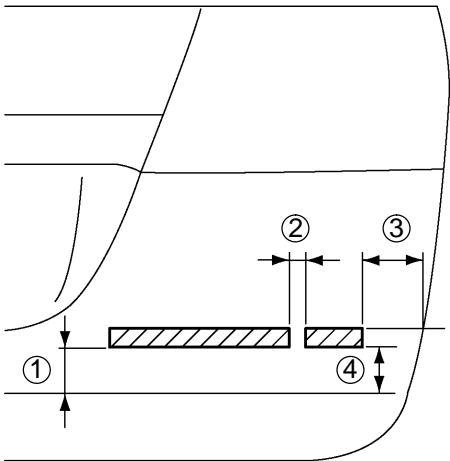

H

B67737

# *SIENNA LE*

## Dimension

①	38.8 (1.528)	②	25.4 (1.000)
③	57.8 (2.276)	④	38.3 (1.508)

mm (in.)

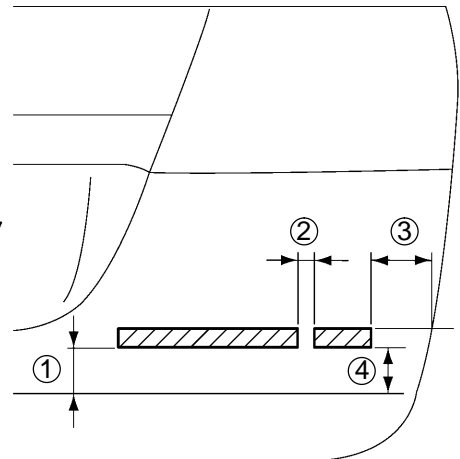

# *SIENNA XLE*

## Dimension

①	38.8 (1.528)	②	8.5 (0.335)
③	52.9 (2.083)	④	38.3 (1.508)

mm (in.)

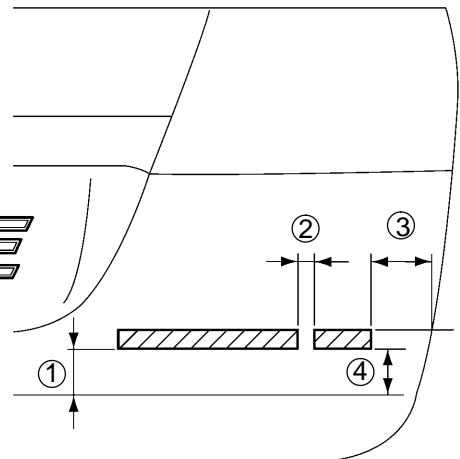

# *SIENNA LE AWD*

## Dimension

①	38.8 (1.528)	②	25.4 (1.000)
③	57.8 (2.276)	④	12.6 (0.496)
⑤	141.3 (5.563)		

mm (in.)

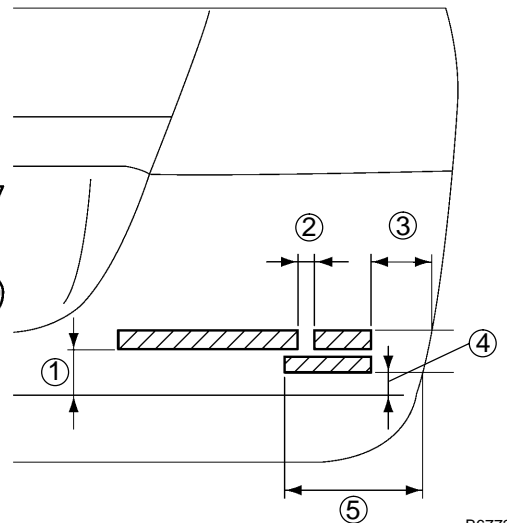

H

B67738

# SIENNA XLE AWD

## Dimension

①	38.8 (1.528)	②	8.5 (0.335)
③	57.8 (2.276)	④	12.6 (0.496)
⑤	141.3 (5.563)	⑥	38.3 (0.496)

mm (in.)

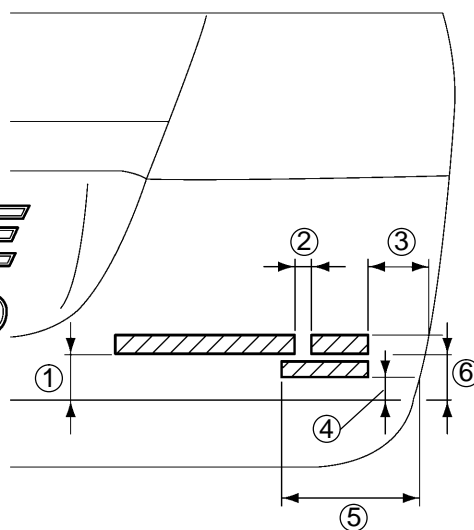

# SIENNA XLE LIMITED

## Dimension

①	38.8 (1.528)	②	8.5 (0.335)
③	52.9 (2.083)	④	12.6 (0.496)
⑤	168.7 (6.642)	⑥	38.3 (0.496)

mm (in.)

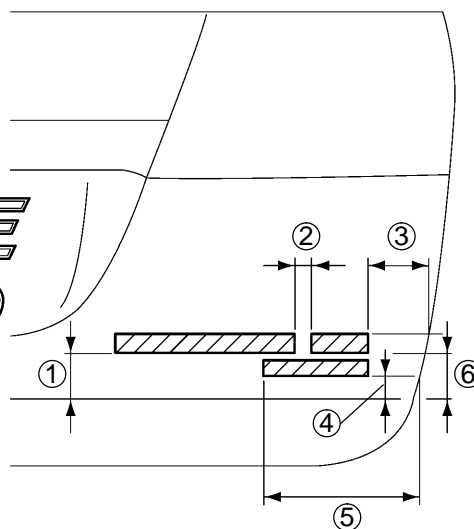

# SIENNA XLE LIMITED AWD

## Dimension

①	38.8 (1.528)	②	8.5 (0.335)
③	52.9 (2.083)	④	12.6 (0.496)
⑤	12.6 (0.496)	⑥	38.3 (0.496)
⑦	8.0 (0.315)	⑧	141.3 (5.563)

mm (in.)

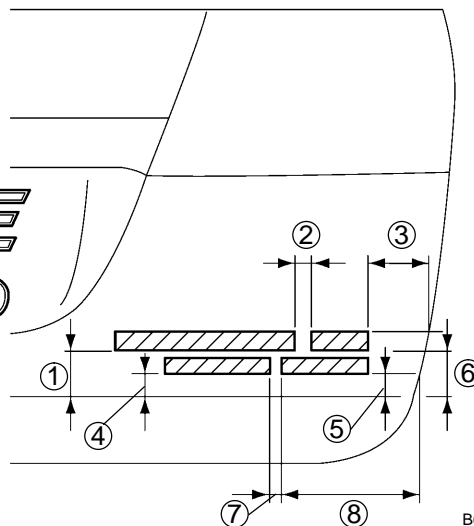

H

B67739



# OUTSIDE MOULDING LH

## REPLACEMENT

760VI-01

### HINT:

On the RH side, use the same procedures as on the LH side.

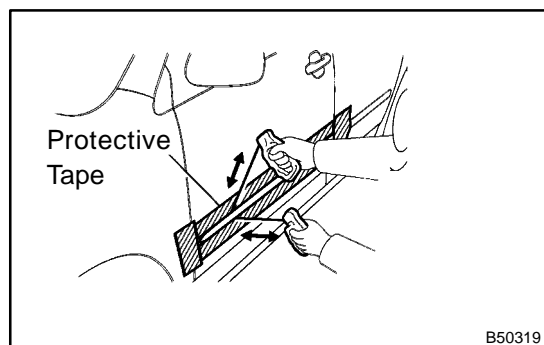

### 1. REMOVE OUTSIDE MOULDING LH

- (a) Using a heat light, heat the moulding between 40 - 60°C (104 - 140°F).

#### NOTICE:

**Do not heat the moulding excessively.**

- (b) Tie both piano wire ends to a wooden block or a similar object.
- (c) Cut off the tape by pulling the piano wire and remove the moulding with reference pins remaining on the moulding.

#### NOTICE:

- ▶ If reusing the moulding, take care not to damage the moulding.
- ▶ Do not damage the body.
- ▶ Be careful of the reference pins on the moulding when removing the moulding.

### 2. INSTALL OUTSIDE MOULDING LH

- (a) Using a heat light, heat the mounting surface of the vehicle body between 40 - 60°C (104 - 140°F).

#### NOTICE:

**Do not heat the body excessively.**

- (b) Remove the tape from the vehicle body.
- (c) Wipe off the stains with cleaner.
- (d) Clean the moulding (if reusing the moulding).
  - (1) Using a heat light, heat the moulding between 20 - 30°C (68 - 86°F).

#### NOTICE:

**Do not heat the moulding excessively.**

- (2) Remove the tape from the moulding.
- (3) Wipe off the stains with cleaner.
- (4) Apply new tape to the moulding, as shown in the illustration.

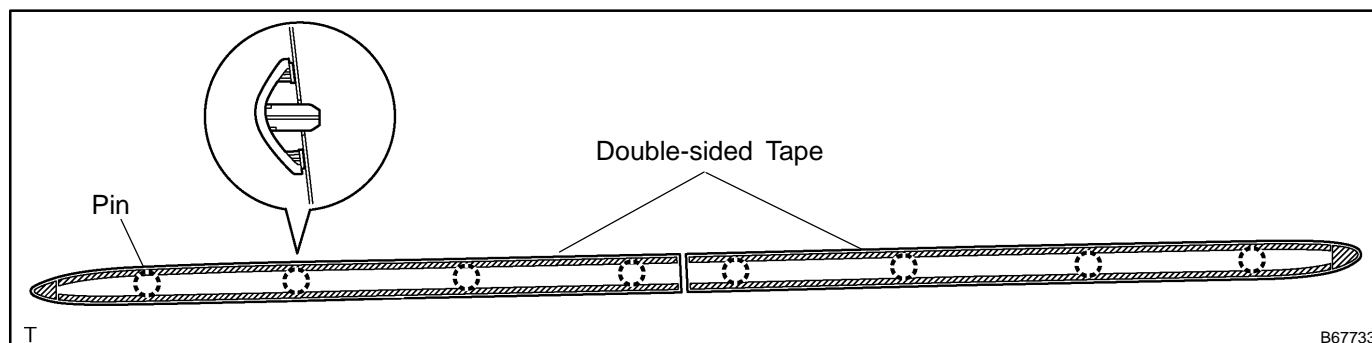

- (e) Match the reference pins on the moulding with the reference holes on the vehicle body.
- (f) Using a heat light, heat the vehicle body and moulding.

**Heating temperature:**

Body	40 - 60°C (104 - 140°F)
Moulding	20 - 30°C (68 - 86°F)

**NOTICE:**

**Do not heat the body and moulding excessively.**

- (g) Release the peeling paper from the face of the moulding and attach the moulding securely to the vehicle body.

**NOTICE:**

**Be careful that dirt or foreign objects do not stick to adhesive part when releasing the peeling paper.**

- (h) Push the moulding to the body.

# FRONT DOOR WINDOW FRAME MOULDING REAR LH REPLACEMENT

760VJ-01

## HINT:

On the RH side, use the same procedure as on the LH side.

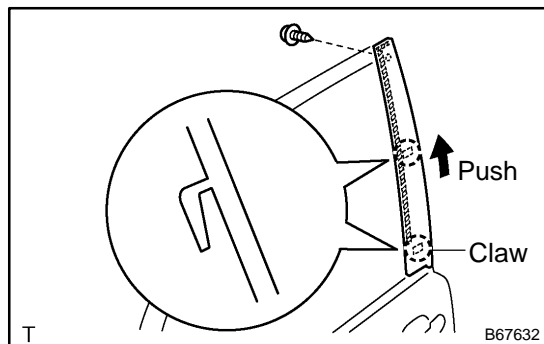

## 1. REMOVE FRONT DOOR WINDOW FRAME MOULDING REAR LH

- Remove the screw.
- Using a heat light, heat the moulding between 40 - 60°C (104 - 140°F).

### NOTICE:

**Do not heat the moulding excessively.**

- Slide the moulding upward to remove the moulding.

### NOTICE:

**If reusing the moulding, take care not to damage the moulding.**

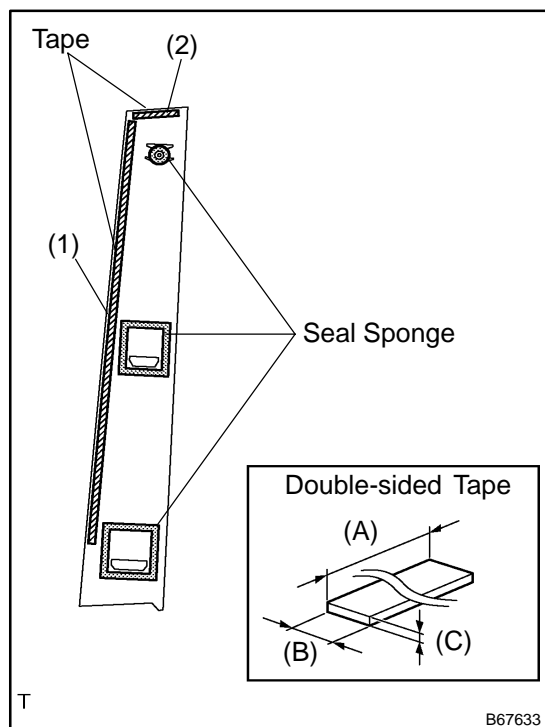

## 2. INSTALL FRONT DOOR WINDOW FRAME MOULDING REAR LH

- Using a shop rag, remove the tape from the moulding.
- Clean the contact surface of the vehicle body with shop rag saturated with white gasoline.
- Clean the outer circumference of the moulding with white gasoline.
- Apply new double-sided tape to the moulding, as shown in the illustration.

### Dimensions:

Length (A)	(1) 470.0 mm (18.504 in.) (2) 43.0 mm (1.693 in.)
Width (B)	5.0 mm (0.197 in.)
Thickness (C)	0.6 mm (0.024 in.)

- Using a heat light, heat the vehicle body and moulding.

### Heating temperature:

Body	40 - 60°C (104 - 140°F)
Moulding	20 - 30°C (68 - 86°F)

### NOTICE:

**Do not heat the body and moulding excessively.**

- Remove the peeling paper from the face of the moulding face.

**HINT:**

Be careful that dirt or foreign objects do not stick to the adhesive part when removing the peeling paper.

- (g) Engage the 2 claws and install the moulding with the screw.

**NOTICE:**

**Do not apply excessive force onto the moulding, but steady pressure with your thumbs.**

# REAR DOOR WINDOW FRAME MOULDING SUB-ASSY LH REPLACEMENT

760VK-02

**HINT:**

On the RH side, use the same procedure as on the LH side.

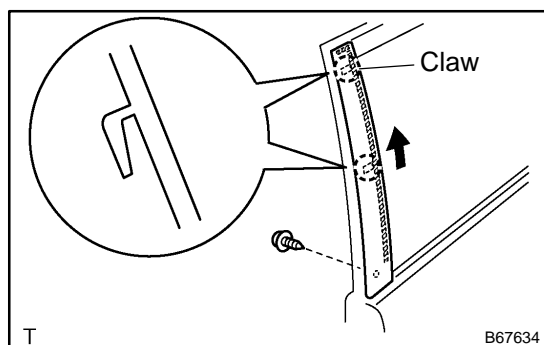

## 1. REMOVE REAR DOOR WINDOW FRAME MOULDING SUB-ASSY LH

- Remove the screw.
- Using a heat light, heat the moulding between 40 - 60°C (104 - 140°F).

**NOTICE:**

**Do not heat the moulding excessively.**

- Slide the moulding upward to remove the moulding.

**NOTICE:**

**If reusing the moulding, take care not to damage the moulding.**

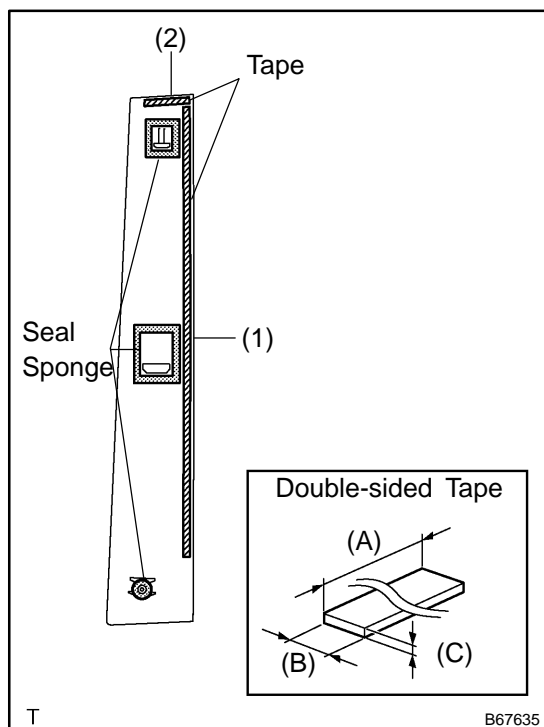

## 2. INSTALL REAR DOOR WINDOW FRAME MOULDING SUB-ASSY LH

- Using a shop rag, remove the tape from the moulding.
- Clean the contact surface of the vehicle body with a shop rag saturated with white gasoline.
- Clean the outer circumference of the moulding with white gasoline.
- Apply new double-sided tape to the moulding, as shown in the illustration.

**Dimension:**

Length (A)	(1) 470.0 mm (18.504 in.) (2) 43.0 mm (1.693 in.)
Width (B)	5.0 mm (0.197 in.)
Thickness (C)	0.6 mm (0.024 in.)

- Using a heat light, heat the vehicle body and moulding.

**Heating temperature:**

Body	40 - 60°C (104 - 140°F)
Moulding	20 - 30°C (68 - 86°F)

**NOTICE:**

**Do not heat the body and moulding excessively.**

- Remove the peeling paper from the moulding face.

**HINT:**

Be careful that dirt or foreign objects do not stick to the adhesive part when removing the peeling paper.

- (g) Engage the 2 claws and install the moulding with the screw.

**NOTICE:**

**Do not apply excessive force onto the moulding, but steady pressure with your thumbs.**

# REAR DOOR WINDOW FRAME MOULDING REAR LH REPLACEMENT

760VL-01

## HINT:

On the RH side, use the same procedure as on the LH side.

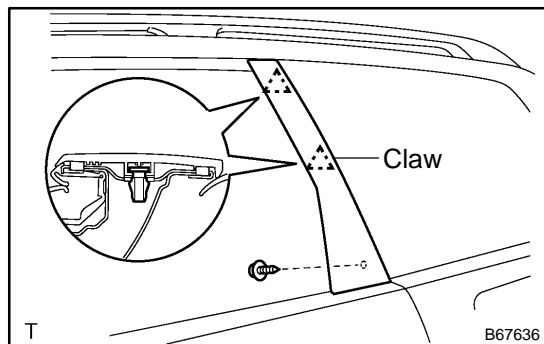

## 1. REMOVE REAR DOOR WINDOW FRAME MOULDING REAR LH

- Remove the screw.
- Using a heat light, heat the moulding between 40 - 60°C (104 - 140°F).

### NOTICE:

**Do not heat the moulding excessively.**

- Slide the moulding upward to remove the moulding.

### NOTICE:

**If reusing the moulding, take care not to damage the moulding.**

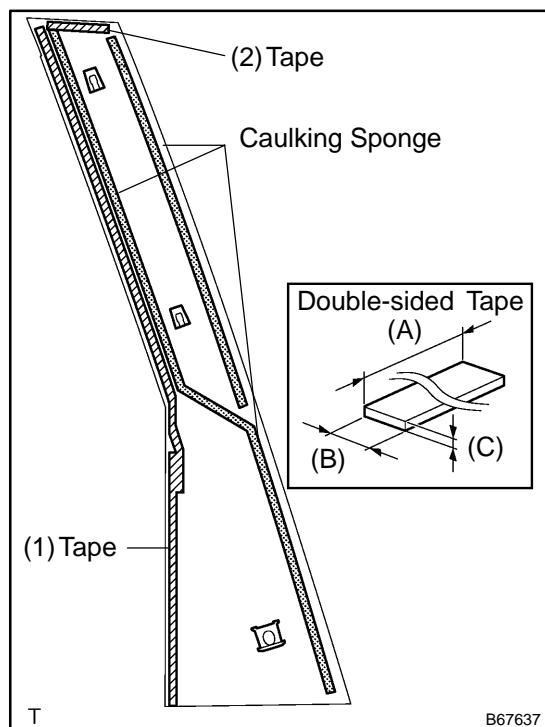

## 2. INSTALL REAR DOOR WINDOW FRAME MOULDING REAR LH

- Using a shop rag, remove the tape from the moulding.
- Clean the contact surface of the vehicle body with a shop rag saturated with white gasoline.
- Clean the outer circumference of the moulding with white gasoline.
- Apply new double-sided tape to the moulding, as shown in the illustration.

### Dimension:

Length (A)	(1) 175.0 mm (6.890 in.)
	(2) 43.0 mm (1.693 in.)
Width (B)	5.0 mm (0.197 in.)
Thickness (C)	(1) 1.6 mm (0.063 in.)
	(2) 0.5 mm (0.020 in.)

- Using a heat light, heat the vehicle body and moulding.

### Heating temperature:

Body	40 - 60°C (104 - 140°F)
Moulding	20 - 30°C (68 - 86°F)

### NOTICE:

**Do not heat the body and moulding excessively.**

- Remove the peeling paper from the moulding.

**HINT:**

Be careful that dirt or foreign objects do not stick to the adhesive part when removing the peeling paper.

- (g) Engage the 2 claws and install the moulding with the screw.

**NOTICE:**

**Do not apply excessive force onto the moulding, but steady pressure with your thumbs.**



## FRONT DOOR GLASS WEATHERSTRIP ASSY OUTER LH REPLACEMENT

760VM-01

### HINT:

- ▶ The installation is in the reverse order of the removal.
  - ▶ On the RH side, use the same procedures as on the LH side.
1. REMOVE FRONT DOOR LOWER FRAME BRACKET GARNISH LH (See page 75-8 )
  2. REMOVE FRONT DOOR INSIDE HANDLE BEZEL PLUG LH (See page 75-8 )
  3. REMOVE FRONT ARMREST BASE PANEL UPPER LH (See page 75-8 )
  4. REMOVE BACK FRAME PLATE LH (See page 75-8 )
  5. REMOVE POWER WINDOW REGULATOR MASTER SWITCH ASSY (See page 75-8 )
  6. REMOVE FRONT DOOR TRIM BOARD SUB-ASSY LH (See page 75-8 )
  7. REMOVE OUTER REAR VIEW MIRROR ASSY LH (See page 75-8 )

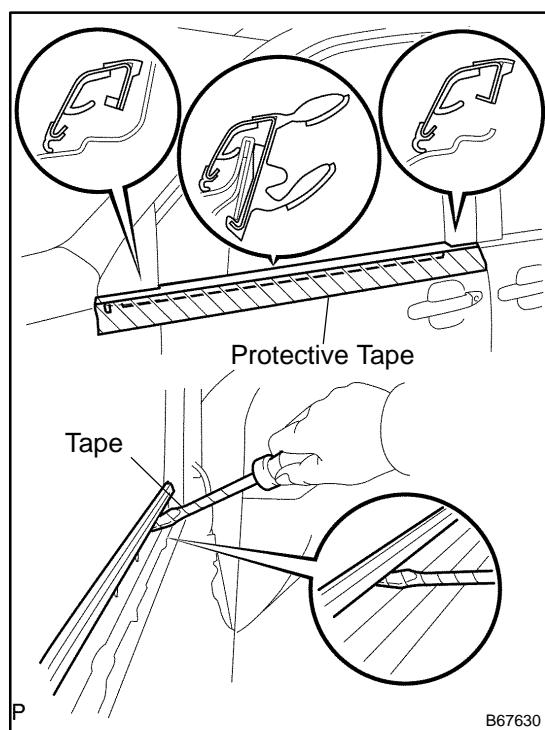

### 8. REMOVE FRONT DOOR GLASS WEATHERSTRIP ASSY OUTER LH

- (a) Put protective tape under the weatherstrip.
- (b) Using a screwdriver or moulding remover, remove the weatherstrip.

### HINT:

Tape the screwdriver tip before use.

## REAR DOOR GLASS WEATHERSTRIP ASSY OUTER LH REPLACEMENT

760VN-02

### HINT:

- ▶ The installation is in the reverse order of the removal.
  - ▶ On the RH side, use the same procedures as on the LH side.
1. REMOVE SLIDE DOOR WINDOW GARNISH LH (See page 75-48 )
  2. REMOVE SLIDE DOOR WINDOW FRAME SUB-ASSY RH (See page 75-48 )
  3. REMOVE SIDE TRIM BOARD COVER REAR LH (See page 75-48 )
  4. REMOVE REAR DOOR TRIM BOARD SUB-ASSY LH (See page 75-48 )
  5. REMOVE REAR DOOR GLASS RUN LH (See page 75-48 )
  6. REMOVE SLIDE DOOR WINDOW ASSY LH (See page 75-48 )

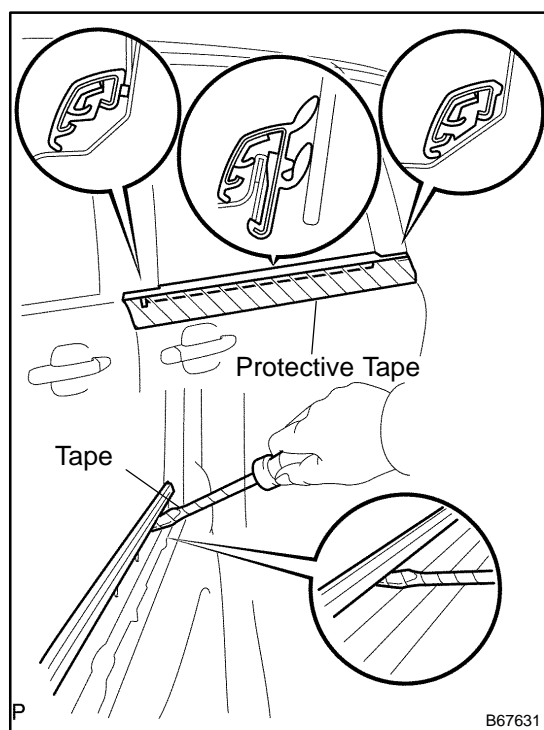

### 7. REMOVE REAR DOOR GLASS WEATHERSTRIP ASSY OUTER LH

- (a) Put protective tape under the weatherstrip.
- (b) Using a screwdriver or moulding remover, remove the weatherstrip.

### HINT:

Tape the screwdriver tip before use.

# BACK DOOR GARNISH SUB-ASSY OUTSIDE REPLACEMENT

760VO-02

## HINT:

The installation is in the reverse order of the removal.

1. REMOVE BACK DOOR GARNISH CENTER (See page 75-108 )
2. REMOVE BACK DOOR SIDE GARNISH LH (See page 75-108 )
3. REMOVE POWER BACK DOOR ROD (W/ POWER BACK DOOR) (See page 75-108 )
4. REMOVE BACK DOOR SIDE GARNISH RH (See page 75-108 )
5. REMOVE BACK DOOR PULL STRAP (See page 75-108 )
6. REMOVE BACK DOOR TRIM BOARD ASSY (See page 75-108 )
7. REMOVE BACK UP LAMP ASSY RH (See page 75-108 )
8. REMOVE BACK UP LAMP ASSY LH (See page 75-108 )
9. REMOVE BACK DOOR GARNISH SUB-ASSY OUTSIDE
  - (a) Disconnect the licence lamp connector.

- (b) Remove the 5 bolts, clip and garnish.

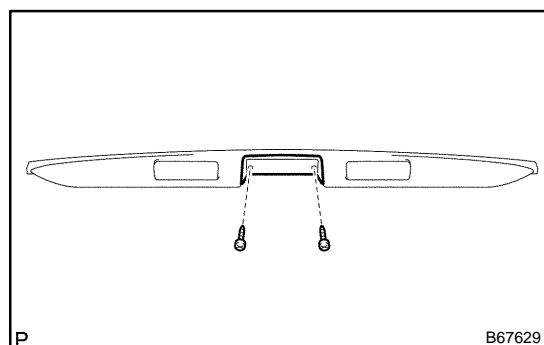
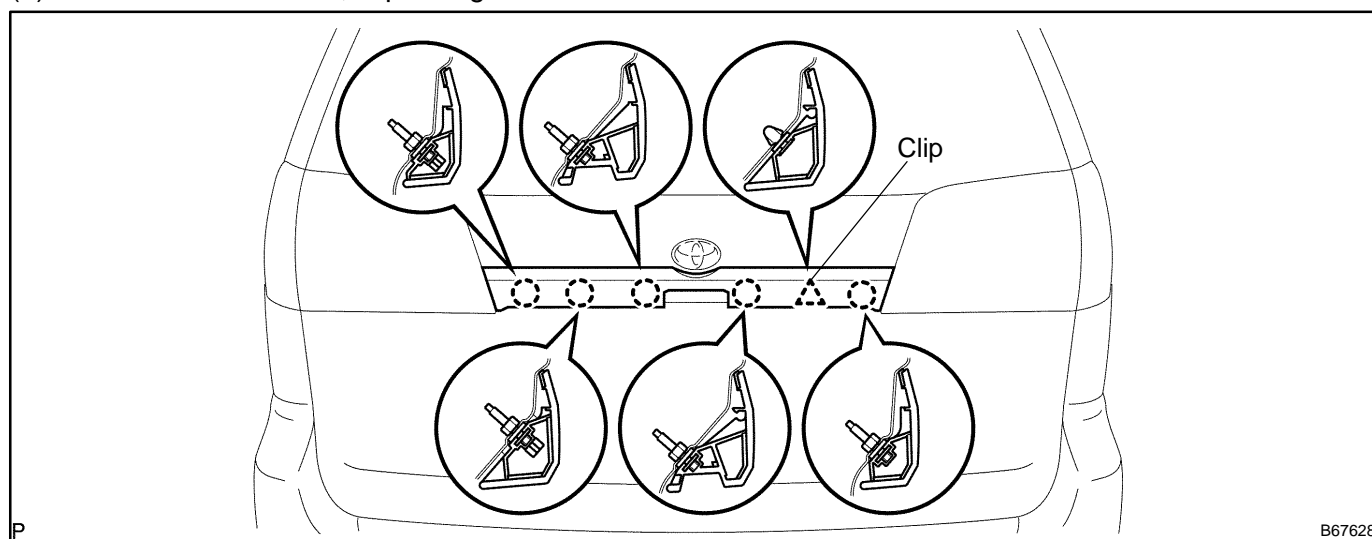

- (c) Remove the 2 screws and opener switch.

# ROOF DRIP SIDE FINISH MOULDING LH REPLACEMENT

760VP-01

## HINT:

On the RH side, use the same procedures as on the LH side.

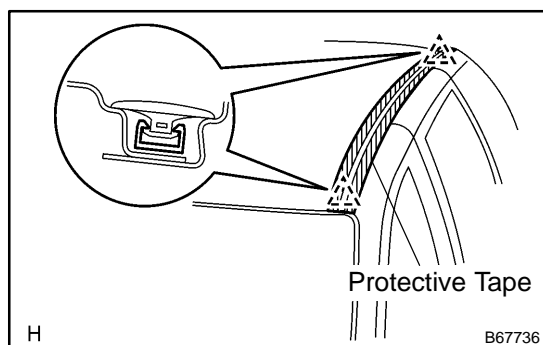

## 1. REMOVE ROOF DRIP SIDE FINISH MOULDING CENTER LH

- Put protective tape around the moulding.
- Using a remover for the roof moulding, disengage of the clips both in the front and rear ends of the moulding and then remove the roof drip side finish moulding.

### NOTICE:

- ▶ Do not remove the clips.
- ▶ If the clips are damaged or removed accidentally, exchange them for supply ones.

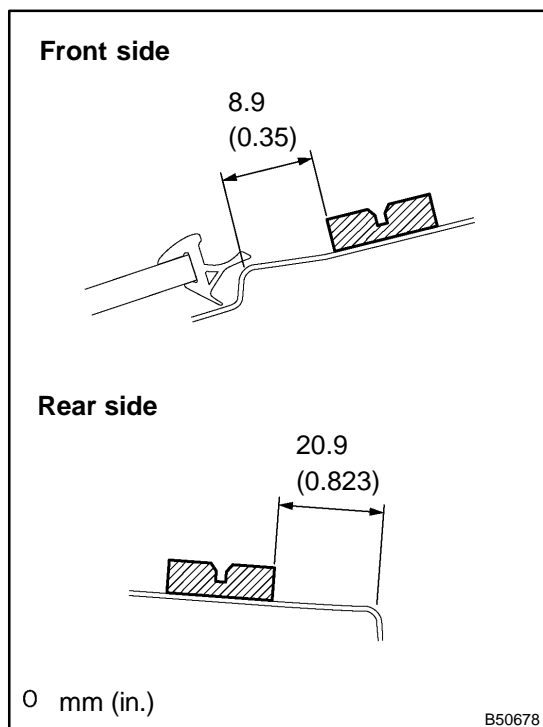

## 2. INSTALL ROOF DRIP SIDE FINISH MOULDING CENTER LH

### NOTICE:

#### Only when exchanging the clips.

- Remove the tape that remains on the mounting surface of the vehicle body and then clean the surface with white gasoline.
- Using a heat light, heat up the clip installation surfaces of the vehicle body and moulding.

#### Heating temperature:

Body	40 - 60°C (104 - 140°F)
Moulding	20 - 30°C (68 - 86°F)

### NOTICE:

#### Do not heat the body and moulding excessively.

- Set the supply clips in the positions as shown in the illustration and press-fit the clips by hand to install them.

### NOTICE:

**Install the moulding when 30 minutes or more have passed after press-fitting the clips.**

### HINT:

- ▶ Initial hardening time: 30 minutes
- ▶ Perfect hardening time: 24 hours

# REAR SPOILER COVER REPLACEMENT

760VQ-01

## HINT:

The installation is in the reverse order of the removal.

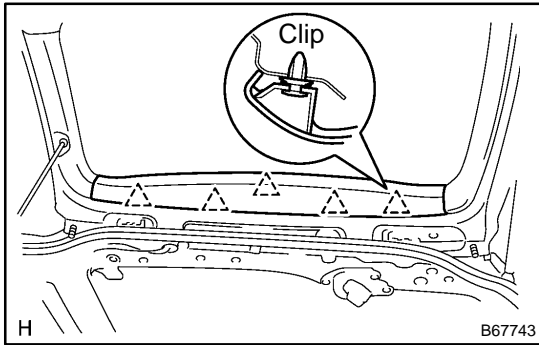

### 1. REMOVE BACK DOOR GARNISH CENTER

- (a) Remove the 5 clips and back door garnish.

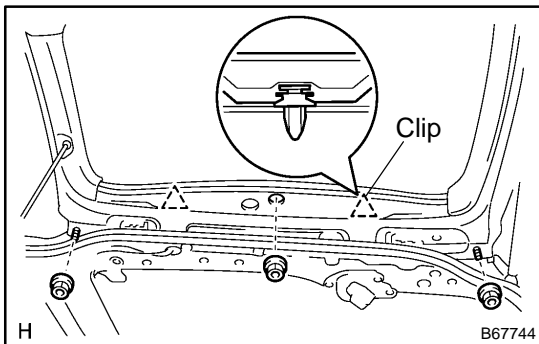

### 2. REMOVE REAR SPOILER COVER

- (a) Remove the 3 nuts and 2 clips.  
(b) Disconnect the stop lamp connector and remove the rear spoiler cover.

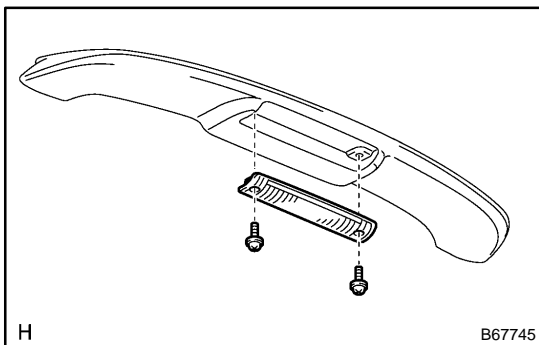

### 3. REMOVE CENTER STOP LAMP ASSY

- (a) Remove the 2 screws.  
(b) Disconnect the stop lamp connector and remove the stop lamp assy.

# FRONT FENDER GARNISH LH REPLACEMENT

760VR-01

**HINT:**

- ▶ The installation is in the reverse order of the removal.
- ▶ On the RH side, use the same procedures as on the LH side.

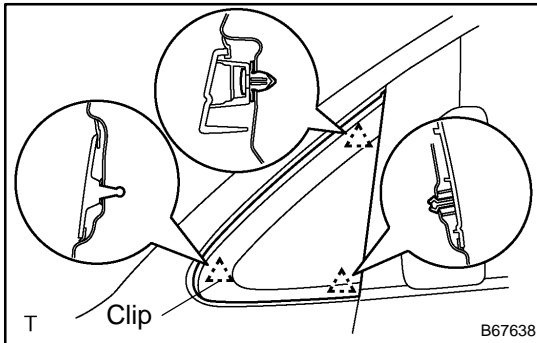
**1. REMOVE FRONT FENDER GARNISH LH**

- (a) Using a moulding remover, remove the 3 clips and front fender garnish.

# FR FLOOR FOOTREST LH REPLACEMENT

760VS-01

**HINT:**

The installation is in the reverse order of the removal.

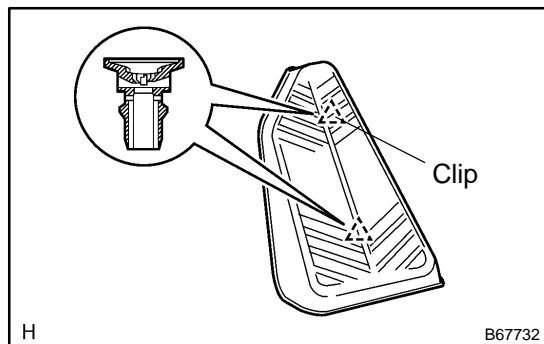

## 1. REMOVE FR FLOOR FOOTREST LH

- (a) Using a screwdriver, disengage the 2 clips and remove the footrest.

**HINT:**

Tape the screwdriver tip before use.

- (b) Disengage the clips and then remove the 2 clips from the footrest.

# ROOF HEADLINING ASSY COMPONENTS

760VB-01

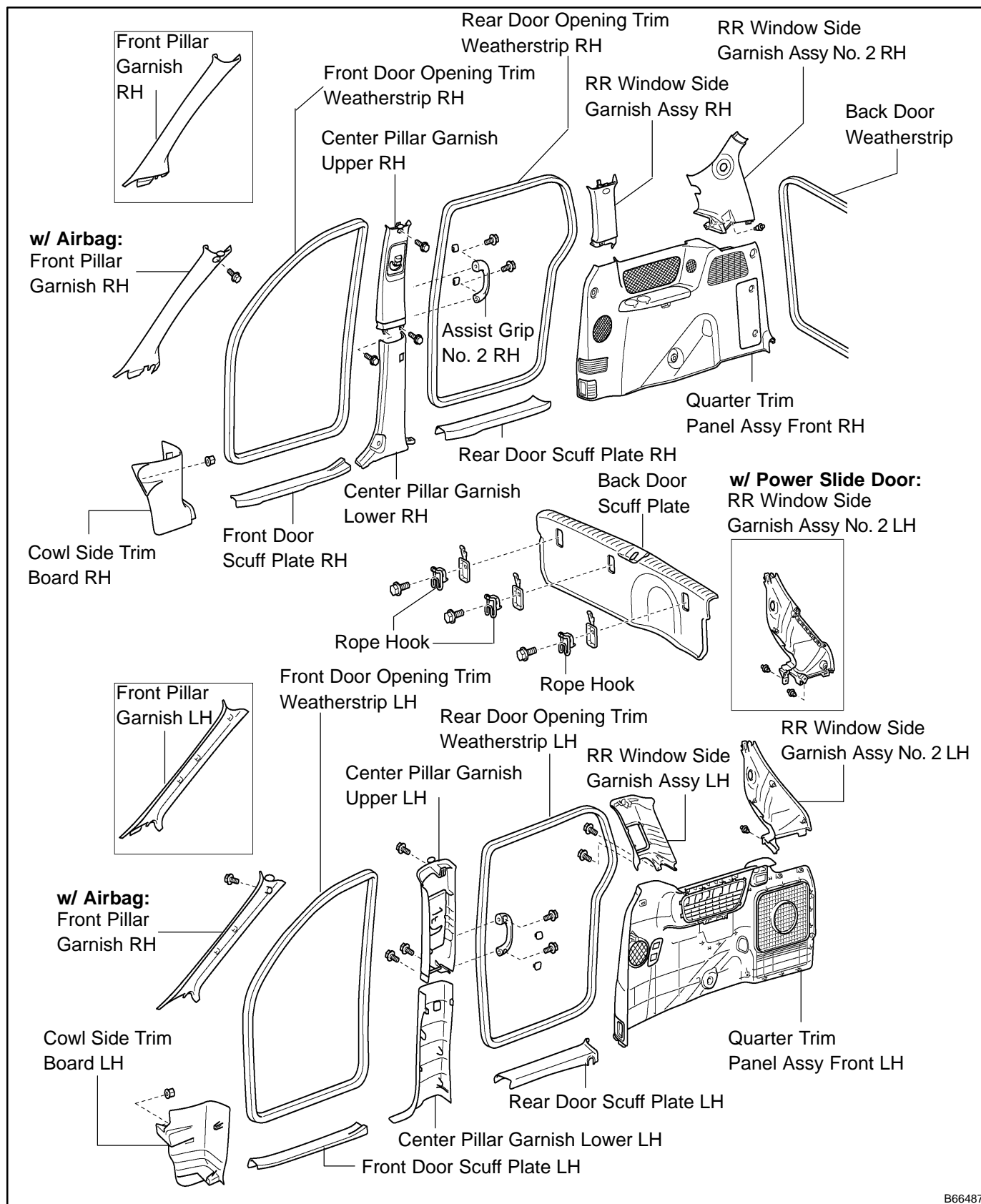

B66487

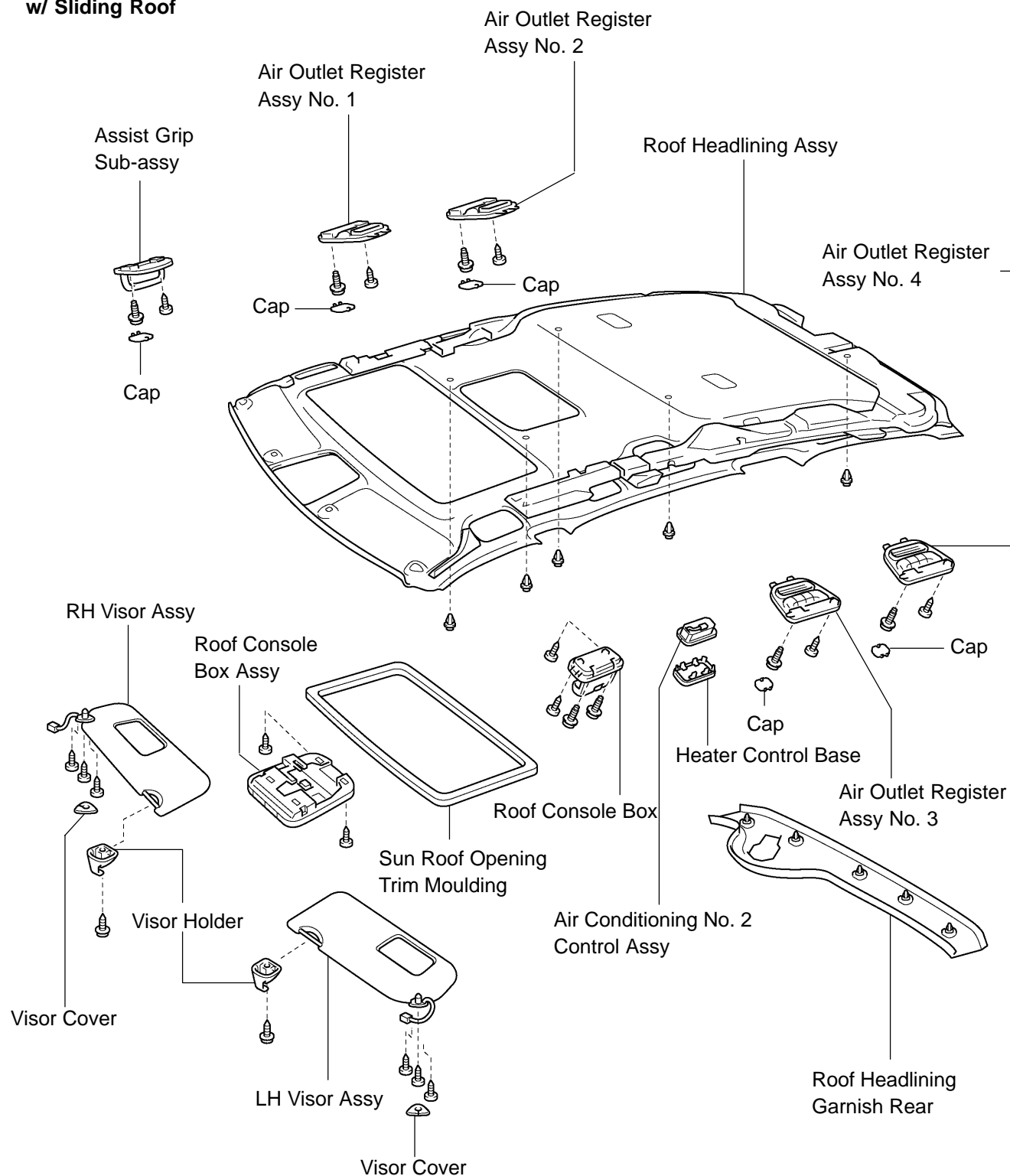

**w/ Sliding Roof**

Y

B66485

## w/o Sliding Roof

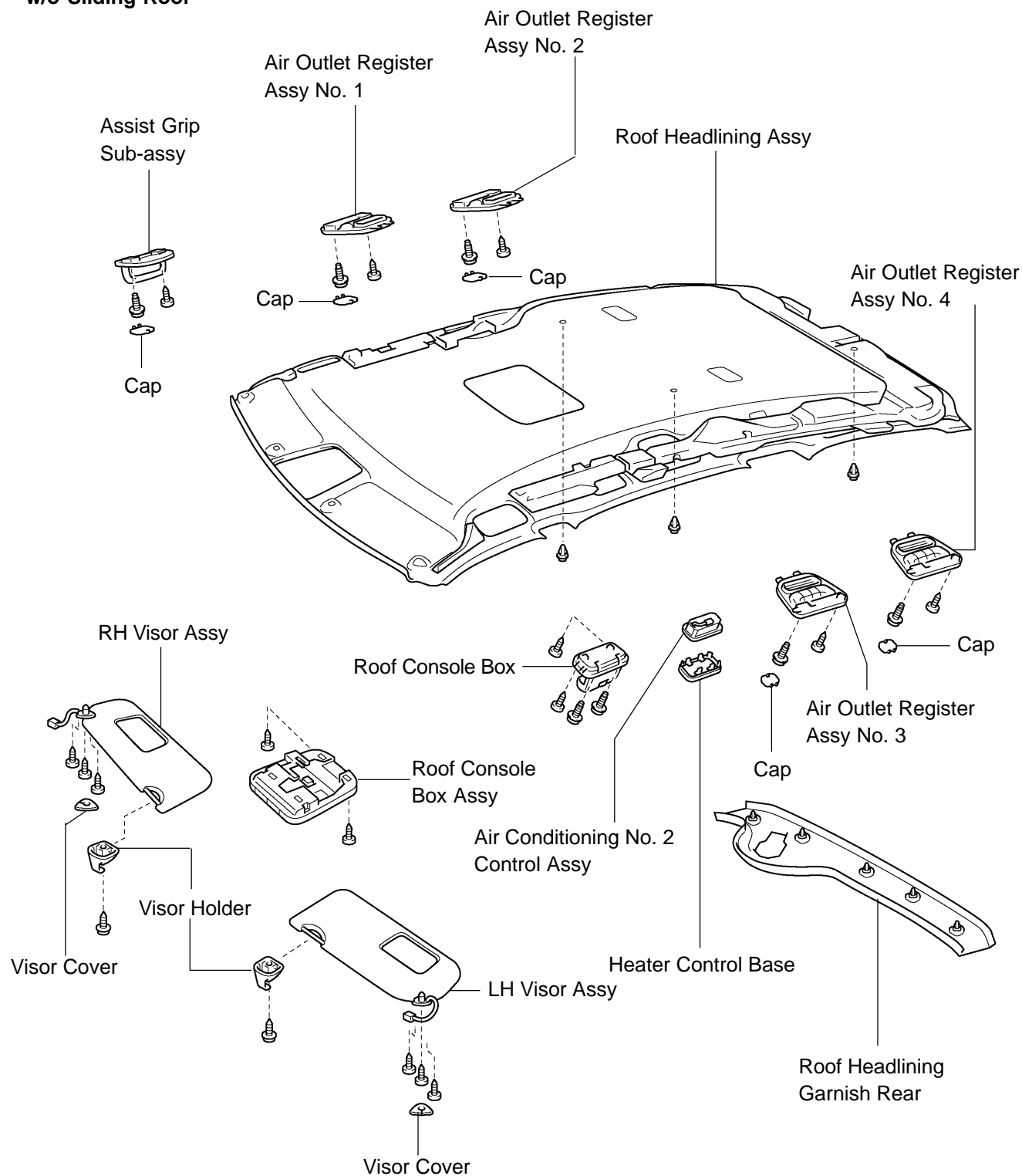

Y

B66486

## REPLACEMENT

### HINT:

- ▶ The installation is in the reverse order of the removal. However, when there is a special point concerning the installation, it is indicated.
- ▶ On the LH side, use the same procedures as on the RH side.

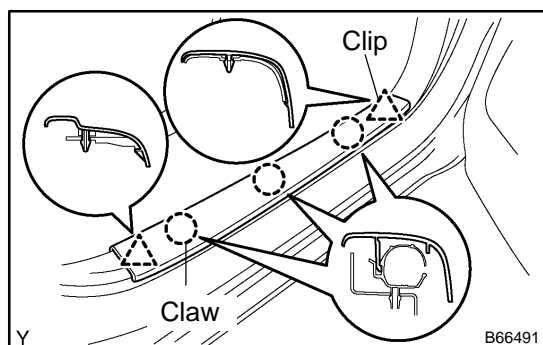

#### 1. REMOVE FRONT DOOR SCUFF PLATE RH

- (a) Using a screwdriver, disengage the 3 clips and 2 claws, and remove the scuff plate.

### HINT:

Tape the screwdriver tip before use.

#### 2. REMOVE FRONT DOOR SCUFF PLATE LH

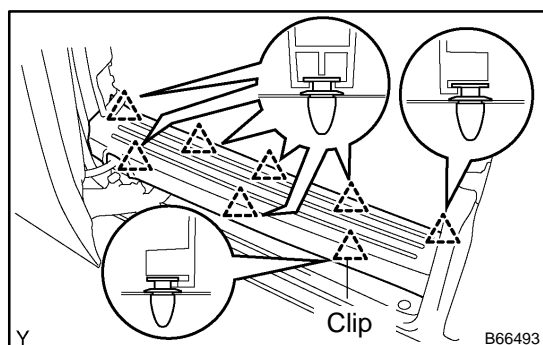

#### 3. REMOVE REAR DOOR SCUFF PLATE RH

- (a) Using a screwdriver, disengage the 8 clips and remove the scuff plate.

### HINT:

Tape the screwdriver tip before use.

#### 4. REMOVE REAR DOOR SCUFF PLATE LH

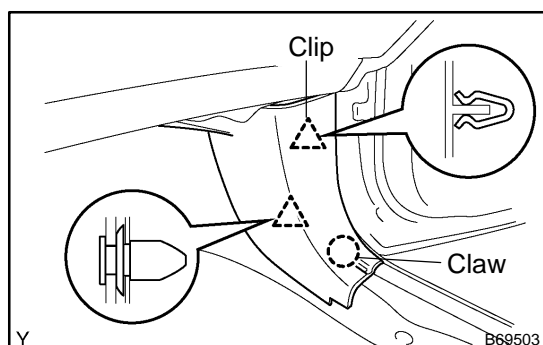

#### 5. REMOVE COWL SIDE TRIM BOARD RH

- (a) Using a screwdriver, disengage the 2 clips and claw, and remove the trim board.

### HINT:

Tape the screwdriver tip before use.

#### 6. REMOVE COWL SIDE TRIM BOARD LH

#### 7. REMOVE FRONT DOOR OPENING TRIM WEATHERSTRIP RH

#### 8. REMOVE FRONT DOOR OPENING TRIM WEATHERSTRIP LH

#### 9. REMOVE REAR DOOR WEATHERSTRIP RH

### HINT:

When reinstalling the weatherstrip, completely remove the sealer adhering to the opening flange on the body side beforehand.

#### 10. REMOVE REAR DOOR WEATHERSTRIP LH

### HINT:

When reinstalling the weatherstrip, completely remove the sealer adhering to the opening flange on the body side beforehand.

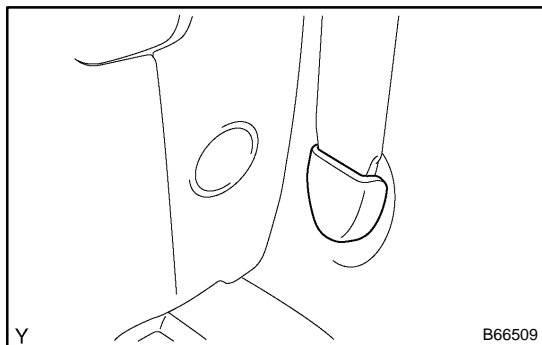
**11. REMOVE CENTER PILLAR GARNISH LOWER RH**

- (a) Remove the floor anchor cover.
- (b) Remove the bolt and disconnect the front seat outer belt on the floor anchor side.

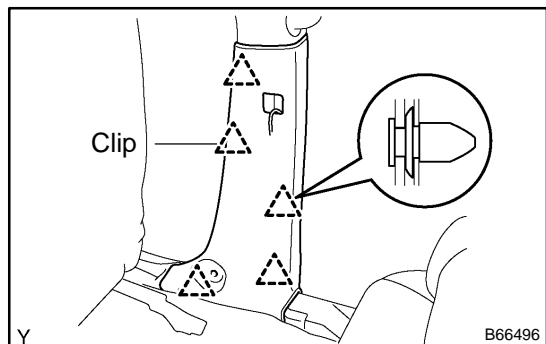

- (c) Using a screwdriver, disengage the 5 clips and remove the pillar garnish.

**HINT:**

Tape the screwdriver tip before use.

- (d) w/ power slide door:  
Disconnect the power slide door control switch RH connector.

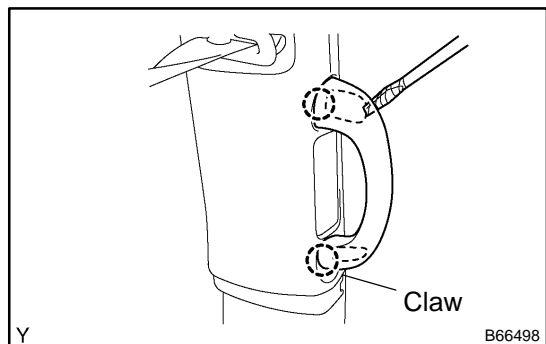
**12. REMOVE CENTER PILLAR GARNISH LOWER LH****13. REMOVE CENTER PILLAR GARNISH UPPER RH**

- (a) Using a screwdriver, disengage the assist grip plugs.

**HINT:**

Tape the screwdriver tip before use.

- (b) Remove the 2 torx® screws and assist grip No. 2 RH.

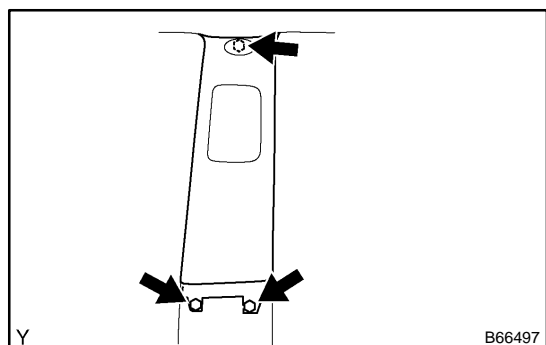

- (c) Remove the 3 bolts.
- (d) Using a screwdriver, disengage the clip and remove the pillar garnish.

**HINT:**

Tape the screwdriver tip before use.

**14. REMOVE CENTER PILLAR GARNISH UPPER LH****HINT:**

Use the same procedures described above for the RH side.

**15. REMOVE BACK DOOR WEATHERSTRIP**

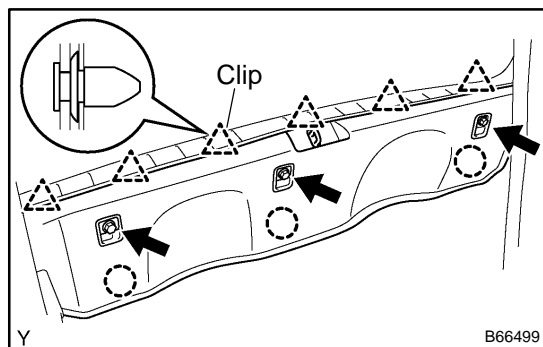
**16. REMOVE BACK DOOR SCUFF PLATE**

- Remove the 3 bolts.
- Using a screwdriver, disengage the 6 clips and remove the scuff plate.

HINT:

Tape the screwdriver tip before use.

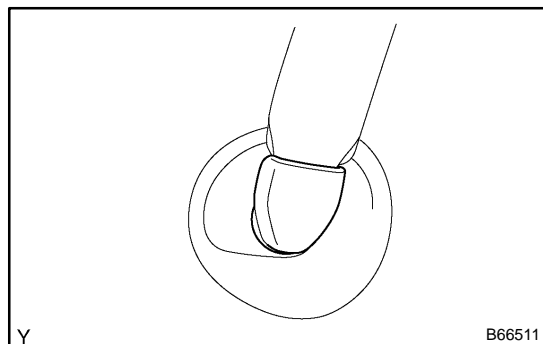
**17. REMOVE QUARTER TRIM PANEL ASSY FRONT RH**

- Remove the floor anchor cover.
- Remove the bolt and disconnect the rear No. 2 seat belt on the floor anchor side.

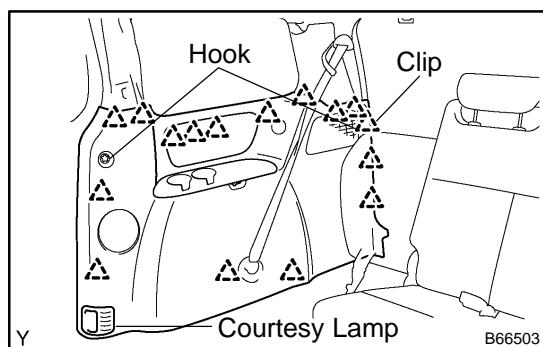

- Remove the 2 package holder net hooks.
- Using a screwdriver, disengage the claw and remove the courtesy lamp.
- Disconnect the courtesy lamp connectors.
- Using a screwdriver, disengage the 16 clips and remove the quarter trim panel assy.

HINT:

Tape the screwdriver tip before use.

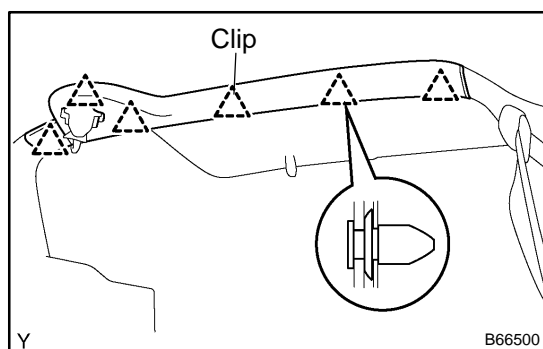
**18. REMOVE QUARTER TRIM PANEL ASSY FRONT LH****19. REMOVE ROOF HEADLINING GARNISH REAR**

- Using a screwdriver, disengage the 6 clips and remove the headlining garnish.

HINT:

Tape the screwdriver tip before use.

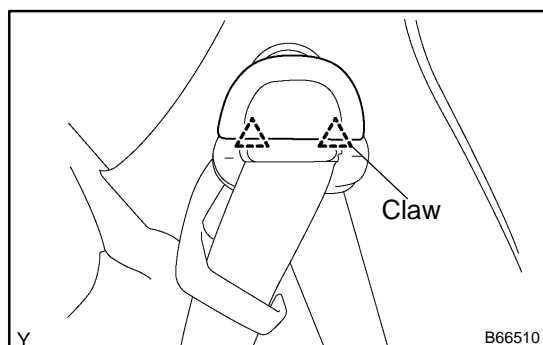
**20. REMOVE RR WINDOW SIDE GARNISH ASSY NO.2 RH**

- Using a screwdriver, disengage the 2 claws and remove the cover of the rear No. 2 seat belt on the shoulder anchor side.

HINT:

Tape the screwdriver tip before use.

- Remove the bolt and disconnect the rear No. 2 seat belt assy on the shoulder anchor side.

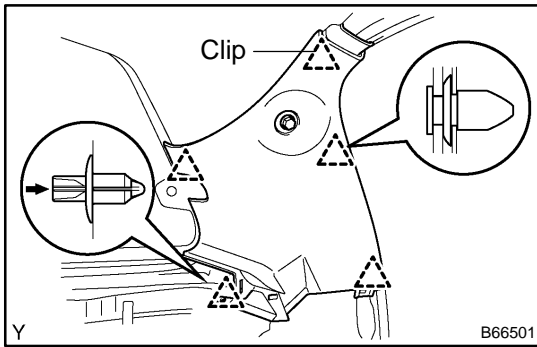

- (c) Using a screwdriver, disengage the 5 clips and remove the side garnish.

HINT:

Tape the screwdriver tip before use.

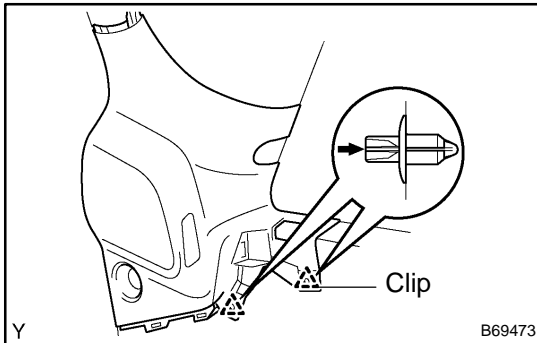

## 21. REMOVE RR WINDOW SIDE GARNISH ASSY NO.2 LH

- (a) w/ power back door:

Using a screwdriver, disengage the 2 clips and remove the window side garnish assy.

HINT:

Tape the screwdriver tip before use.

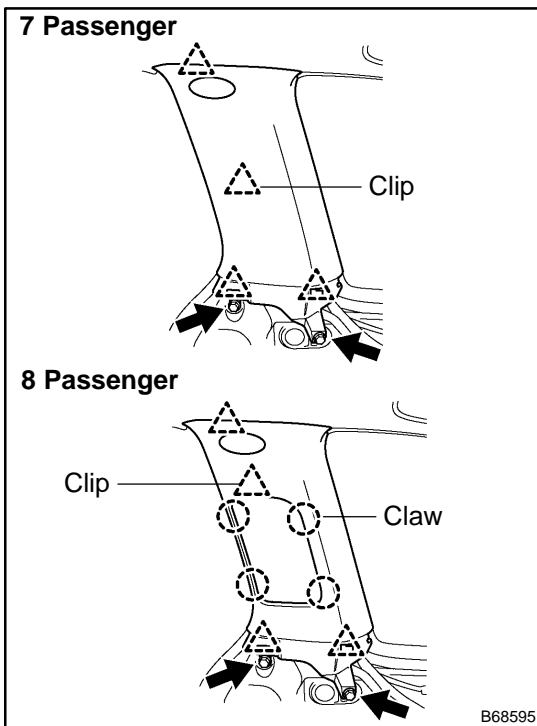

## 22. REMOVE RR WINDOW SIDE GARNISH ASSY RH

- (a) Remove the bolt and screw.

- (b) 7-passenger:

Using a screwdriver, disengage the 4 clips and remove the window side garnish assy.

HINT:

Tape the screwdriver tip before use.

- (c) 8-passenger:

Using a screwdriver, disengage the 4 clips and 4 claws, and remove the window side garnish assy.

HINT:

Tape the screwdriver tip before use.

## 23. REMOVE RR WINDOW SIDE GARNISH ASSY LH

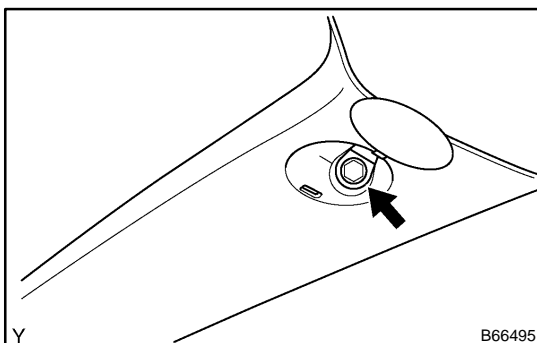

## 24. REMOVE FRONT PILLAR GARNISH RH

- (a) w/ curtain shield airbag:

Using a screwdriver, disengage the cover of the pillar garnish and bolt.

HINT:

Tape the screwdriver tip before use.

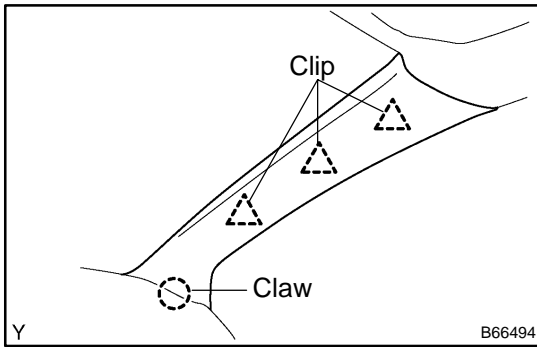

- (b) Using a screwdriver, disengage the 3 clips and claw and remove the pillar garnish.

HINT:

Tape the screwdriver tip before use.

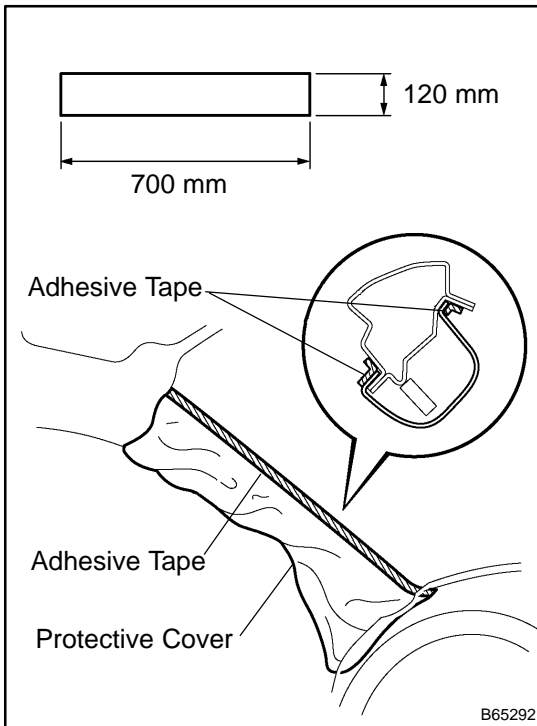

- (c) Pull the garnish upward and remove it from the instrument panel.

- (d) w/ curtain shield airbag:

Protect the curtain shield airbag LH.

- (1) Thoroughly cover the airbag with cloth or nylon of 700 mm (27.56 in.) x 120 mm (4.72 in.) and fix the ends of the cover with adhesive tape, as shown in the illustration.

**NOTICE:**

**Cover the curtain shield airbag with the protection cover as soon as the pillar garnish is removed.**

## 25. REMOVE FRONT PILLAR GARNISH LH

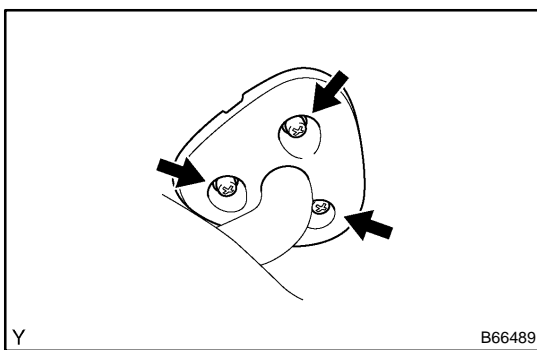

## 26. REMOVE RH VISOR ASSY

- (a) Using a screwdriver, disengage the 2 claws and remove the visor cover.

HINT:

Tape the screwdriver tip before use.

- (b) Remove the 3 screws and visor.

## 27. REMOVE LH VISOR ASSY

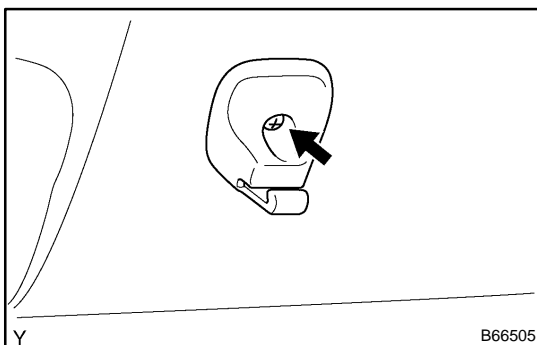

## 28. REMOVE VISOR HOLDER

- (a) Remove the screw and visor holder.

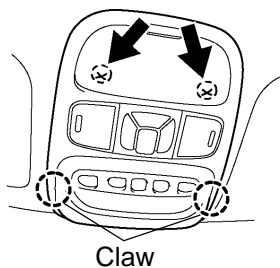
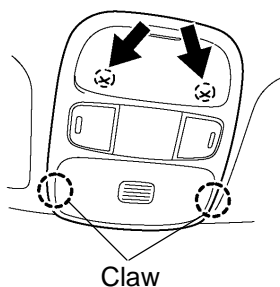
**w/ Sliding Roof****w/o Sliding Roof**

Y

B66506

**29. REMOVE ROOF CONSOLE BOX ASSY**

- (a) Remove the 2 screws and console box assy.
- (b) Using a moulding remover, disengage the 2 claws.
- (c) Disconnect the map lamp switch connector and sliding roof switch connector and remove the console box.

Claw

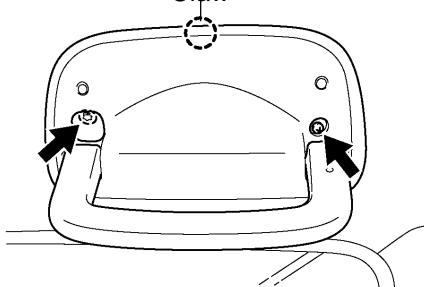

Y

B66507

**30. REMOVE ASSIST GRIP SUB-ASSY**

- (a) Using a screwdriver, disengage the claw and remove the assist grip cover.

**HINT:**

Tape the screwdriver tip before use.

- (b) Remove the torx<sup>®</sup>, screw and assist grip sub-assy.

**31. REMOVE ROOF CONSOLE BOX**

- (a) Remove the 2 torx<sup>®</sup> screws, 2 screws and roof console box.

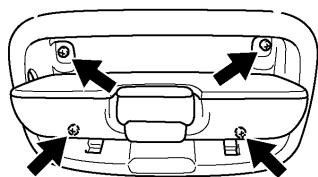

Y

B66490

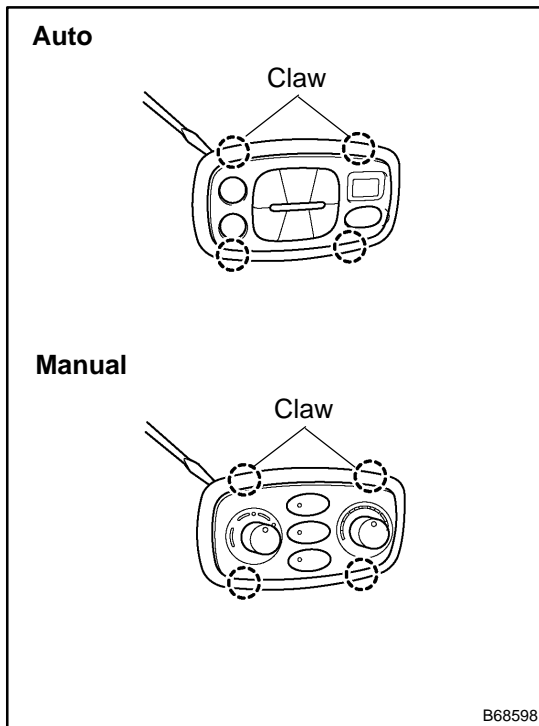

**32. REMOVE AIR CONDITIONING NO.2 CONTROL ASSY**

- (a) Using a screwdriver, disengage the 4 claws and remove the heater control base.

HINT:

Tape the screwdriver tip before use.

- (b) Remove the No. 2 control assy.  
(c) Disconnect the No. 2 control connector.

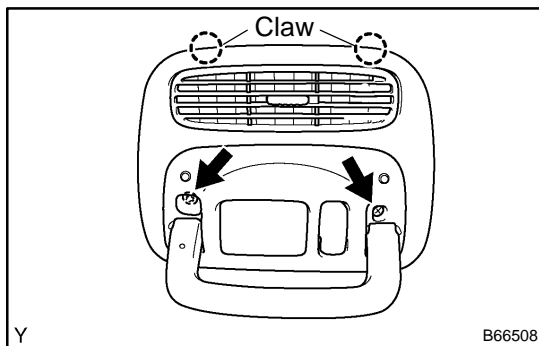
**33. REMOVE AIR OUTLET REGISTER ASSY NO.1**

- (a) Using a screwdriver, disengage the 2 claws, and remove the cover.

HINT:

Tape the screwdriver tip before use.

- (b) Remove the bolt, screw and air outlet register.

**34. REMOVE AIR OUTLET REGISTER ASSY NO.2****35. REMOVE AIR DUCT REGISTER ASSY NO.3****36. REMOVE AIR OUTLET REGISTER ASSY NO.4****37. REMOVE SUN ROOF OPENING TRIM MOULDING (W/ SLIDING ROOF)**

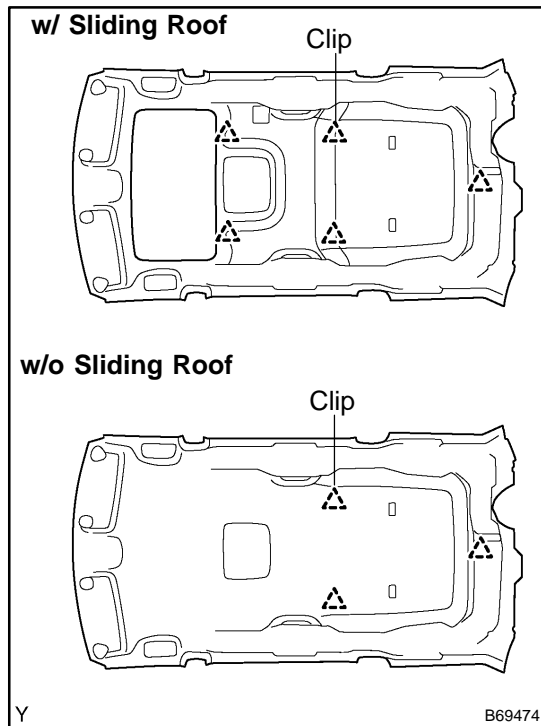
**38. REMOVE ROOF HEADLINING ASSY**

- (a) w/ sliding roof:  
Using a clip remover, disengage the 5 clips and remove the roof headlining assy.
- (b) w/o sliding roof:  
Using a clip remover, disengage the 3 clips and remove the roof headlining assy.

**NOTICE:**

In order to prevent the roof headlining from becoming bent, work must be performed by 2 or more persons when removing/installing it.

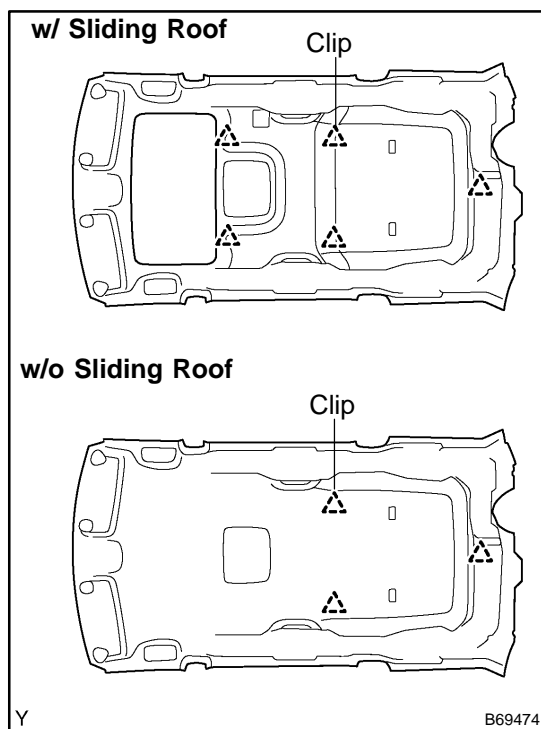
**39. INSTALL ROOF HEADLINING ASSY**

- (a) w/ sliding roof:  
Install the roof headlining with the 5 clips.
- (b) w/o sliding roof:  
Install the roof headlining with the 3 clips.

**NOTICE:**

In order to prevent the roof headlining from becoming bent, work must be performed by 2 or more persons when removing/installing it.

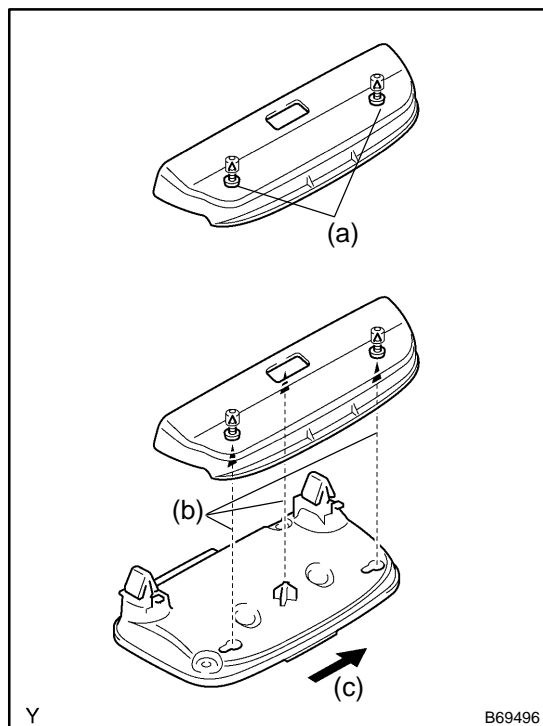
**40. INSTALL ROOF CONSOLE BOX**

- (a) Temporarily install the 2 screws to the retainer.
- (b) Set the console box, as shown in the illustration.
- (c) Slide the console box in the direction indicated by the arrow mark in the illustration so that the screws can meet the keyholes.
- (d) Tighten the 2 screws.
- (e) Tighten the 2 torx<sup>®</sup> screws.